

BEFORE THE BOARD OF COUNTY COMMISSIONERS  
FOR MULTNOMAH COUNTY, OREGON

In the Matter of Execution and  
Acceptance of Deed of Dedication  
and Easement from Multnomah  
County to the Public Certain Real  
Property for County Road Purposes

) ORDER AUTHORIZING EXECUTION  
) AND ACCEPTANCE OF  
) DEED AND EASEMENT  
) FOR COUNTY ROAD PURPOSES  
)  
) N.E. BLUE LAKE ROAD,  
) ITEM NO. 95-10 and  
) N.E. 223RD AVENUE,  
) ITEM NO. 95-13  
)  
) BOARD ORDER NO. 95-242  
)

WHEREAS the above entitled matter is before the Board of County Commissioners for the execution and acceptance of a Deed of Dedication conveying certain real property to the public for road purposes and an Easement for the construction and maintenance of storm drainage facilities on real property; and

WHEREAS Multnomah County is the owner of said properties, and based on the recommendation of the Director of the Department of Environmental Services, the properties as described in said documents are necessary for use as part of the county road system;

WHEREAS Charles Ciecko, Director of Metro Regional Parks and Greenspaces, also recommends, via letter to the Board of County Commissioners, the execution and acceptance of said deed and easement because the properties described therein are necessary to improve road and drainage conditions near Blue Lake Park, which results in improved conditions for the Metro Regional Parks and Greenspaces, (said letter of recommendation to the Board being attached to this Board Order);

NOW, THEREFORE, IT IS HEREBY ORDERED:

1. That the real properties as described in the attached Deed of Dedication (Item No. 95-10) and Easement (Item No. 95-13), are to be conveyed to the public, and that the deed and easement documents shall be executed by the Chair and accepted by the Board of County Commissioners, and the properties therein described are to be used as part of the county road system.
2. That the real property as described in the Deed of Dedication be included as a portion of N.E. Blue Lake Road, County Road No. 1272 (West of N.E. 223rd Avenue) and the real property as described in the Easement be included as a portion of N.E. 223rd Avenue, County Road No. 3404 (North of N.E. Blue Lake Road).

ORDER AUTHORIZING DEED OF  
DEDICATION and EASEMENT  
N.E. Blue Lake Road,  
Item No. 95-10 and  
N.E. 223rd Avenue,  
Item No. 95-13  
Page 2

3. That the executed Deed of Dedication and Easement, along with this executed Board Order, shall be forwarded to the Multnomah County Recording Office for recording purposes.

DATED this 21st day of November, 1995.



BOARD OF COUNTY COMMISSIONERS  
FOR MULTNOMAH COUNTY, OREGON

By *Beverly Stein*  
BEVERLY STEIN/Chair

REVIEWED:

LAURENCE KRESSEL  
County Counsel  
for Multnomah County, Oregon

By *John L. DuBay*  
JOHN L. DuBAY  
Chief Asst. County Counsel



METRO

October 16, 1995

Board of County Commissioners  
Multnomah County Courthouse  
1120 SW Fifth Avenue/Room 1515  
Portland, Oregon 97204

RE: NE 223rd Avenue and NE Blue Lake Road Property Transfer

Dear Commissioners:

I have reviewed and approve the attached original drainage easement document (said easement area located East of NE 223rd Avenue), and the deed of dedication document (said dedication area realigns NE Blue Lake Road).

This property is Multnomah County property which is a portion of Blue Lake Park. The dedication and easement transfer property to public road use and as drainage facility use for improved traffic safety and drainage consideration.

The dedication and easement also improve conditions for the Metro Regional Parks and Greenspaces, as well as the Transportation Division, by improving public road and drainage conditions near Blue Lake Park.

Metro supports this cooperative action which is creating a positive improvement for all parties involved.

Sincerely,

Charles Ciecko  
Director, Regional Parks and Greenspaces

CC/mb  
proptran.let

N.E. BLUE LAKE ROAD  
West of N.E. 223rd Avenue  
Item No. 95-10  
October 11, 1995

DEED OF DEDICATION

MULTNOMAH COUNTY conveys to MULTNOMAH COUNTY, a political subdivision of the State of Oregon, for road purposes, the following described property:

A tract of land situated in the Southeast One-quarter of Section 21, T1S, R3E, W.M., Multnomah County, Oregon, more particularly described as follows:

Beginning at an iron rod at the intersection of the North right-of-way line of N.E. Blue Lake Road, County Road No. 1272, said iron rod being northerly 20.00 feet when measured at right angles to the centerline thereof, and the West right-of-way line of N.E. 223rd Avenue, County Road No. 3404, said iron rod also being 40.00 feet westerly when measured at right angles to the centerline thereof; thence N 19°44'30" E along the West right-of-way line of said N.E. 223rd Avenue, a distance of 254.39 feet to a point; thence southwesterly along the arc of a 30.00 foot radius curve to the right, the chord of which bears S 30°21'37" W, 46.03 feet, an arc length of 52.48 feet to a point being 30.00 feet northerly, when measured at right angles to the centerline of the New N.E. Blue Lake Road; thence westerly along the North line of said New N.E. Blue Lake Road along an arc of a 220 foot radius curve to the right, the chord of which bears N 85°06'49" W, 109.60 feet, an arc length of 110.77 feet to a point; thence N 70°41'22" W, a distance of 15.53 feet to a point of curvature; thence westerly along an arc of a 430 foot

AFTER RECORDING, RETURN TO:  
Pat Hinds/Bldg. #425

FOR TAX STATEMENTS:  
Multnomah County  
Transportation Division  
1620 SE 190th Avenue  
Portland OR 97233

radius curve to the left, the chord of which bears N 84°52'31" W, 210.76 feet, an arc length of 212.93 feet to a point; thence S 80°56'20" W, a distance of 17.16 feet to a point being 30.00 feet northerly when measured at right angles to the centerline of both said New N.E. Blue Lake Road and said N.E. Blue Lake Road; thence continuing S 80°56'20" W, along a line parallel to and 30.00 feet northerly of the centerline of the existing N.E. Blue Lake Road, a distance of 222.62 feet to a point; thence S 9°03'40" E, a distance of 10.00 feet to a point being 20.00 feet northerly when measured at right angles to the centerline of said N.E. Blue Lake Road; thence N 80°56'20" E along the existing North right-of-way line of said N.E. Blue Lake Road, a distance of 222.62 feet to a point; thence southeasterly along an arc of a 306.48 foot curve to the right, the chord of which bears S 76°37'40" E, 233.91 feet, an arc length of 239.99 feet to a point; thence S 54°13'01" E, a distance of 284.47 feet to the point of beginning.

Containing 27,700 square feet, more or less.

As shown on EXHIBIT "A", attached hereto and made a part of this document.

N.E. BLUE LAKE ROAD  
West of N.E. 223rd Avenue  
Item No. 95-10  
October 11, 1995  
Page 3

The true and actual consideration for this conveyance is \$0.00.

DATED this 21st day of November, 1995.



MULTNOMAH COUNTY, OREGON

By

Beverly Stein  
BEVERLY STEIN/Chair  
Board of County Commissioners  
for Multnomah County, Oregon

STATE OF OREGON County of Multnomah

SIGNED BEFORE ME November 21, 1995, personally appeared  
Beverly Stein, who, being sworn, stated that she is the  
Chair of the Board of County Commissioners of Multnomah County, Oregon, and that  
this instrument was voluntarily signed in behalf of said county by authority of its  
Board of County Commissioners.

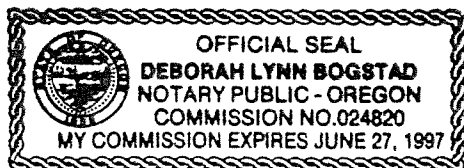

Deborah Lynn Bogstad  
Notary Public for said State

My Commission expires June 27, 1997

REVIEWED:

LAURENCE KRESSEL  
County Counsel  
for Multnomah County, Oregon

By

John L. DuBay  
JOHN L. DuBAY  
Chief Asst. County Counsel

# EXHIBIT "A"

----- CENTERLINE

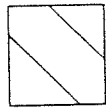

RIGHT-OF-WAY DEDICATION

NEW N.E. BLUE LAKE RD.  
CENTERLINE

N.E. 223RD AVE.

N.E. BLUE LAKE RD.

DEDICATION

NO SCALE

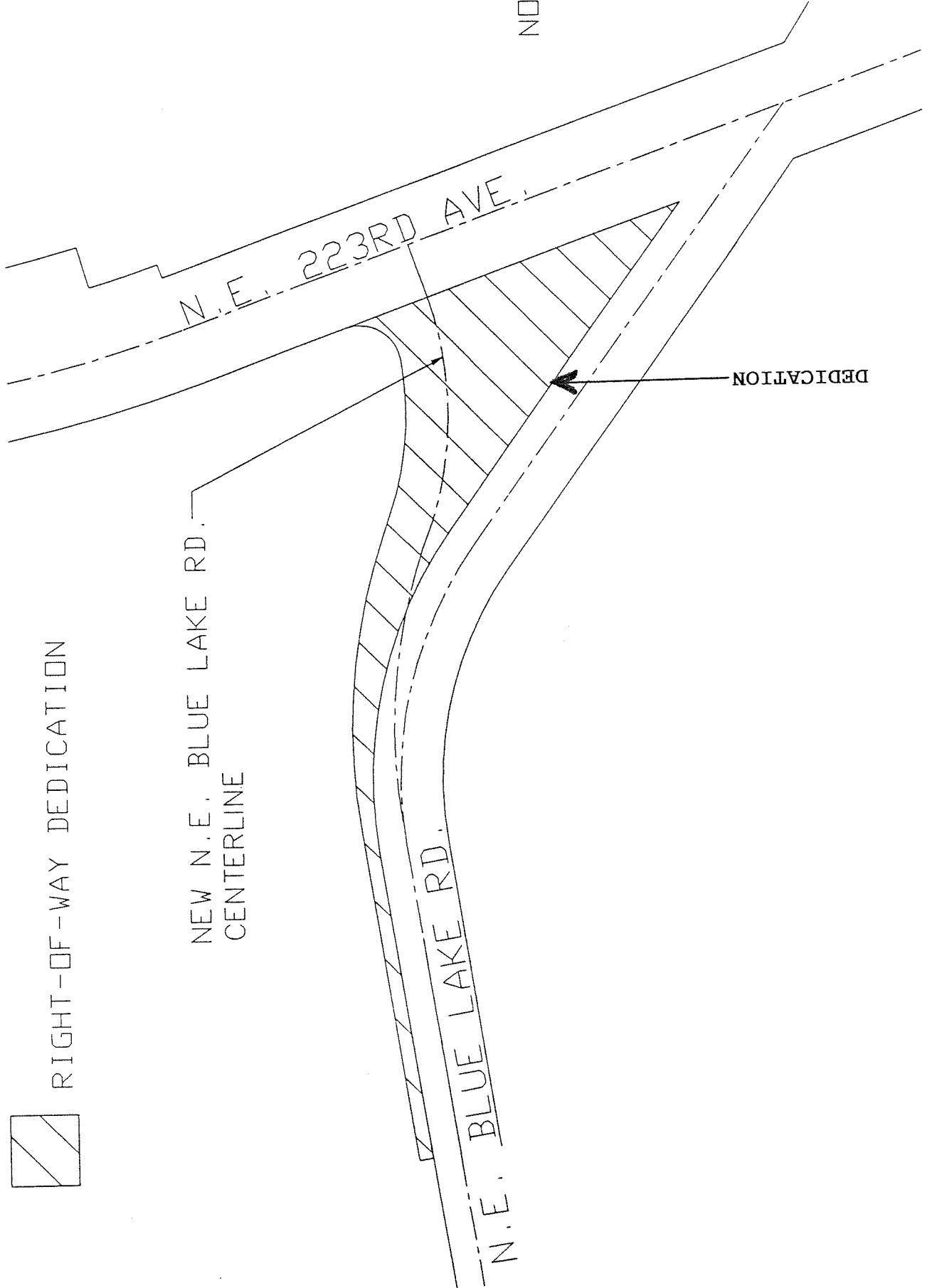
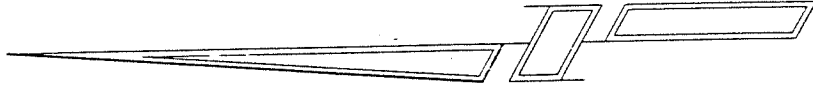

N.E. 223RD AVENUE  
North of N.E. Blue Lake Road  
Item No. 95-13  
October 11, 1995

EASEMENT

MULTNOMAH COUNTY conveys to MULTNOMAH COUNTY, a political subdivision of the State of Oregon, a perpetual easement for the construction and maintenance of storm drainage facilities through, over, under, along and within the following described parcel of land:

A strip of land situated in the Southeast One-quarter of Section 21, T1S, R3E, W.M., Multnomah County, Oregon, more particularly described as follows:

Beginning at Engineers Centerline Station 48+32.5 of N.E. 223rd Avenue, County Road No. 3404; thence N 70°15'30" E at right angles to the centerline of said N.E. 223rd Avenue, a distance of 150.00 feet to a point; thence N 19°44'30" W, a distance of 15.00 feet to a point; thence S 70°15'30" W, a distance of 150.00 feet to a point on the centerline of said N.E. 223rd Avenue, said point being N 19°44'30" W, 15.00 feet from the point of beginning; thence S 19°44'30" E, a distance of 15.00 feet to the point of beginning.

Containing 2,250 square feet, more or less.

As shown on attached map marked EXHIBIT "A", and hereby made a part of this document.

It is understood and agreed that no buildings shall be erected upon said easement without the written consent of the Board of County Commissioners.

AFTER RECORDING, RETURN TO:  
Pat Hinds/Bldg. #425

FOR TAX STATEMENTS:  
Multnomah County  
Transportation Division  
1620 SE 190th Avenue  
Portland OR 97233



N.E. 223RD AVENUE  
North of N.E. Blue Lake Road  
Item No. 95-13  
October 11, 1995  
Page 2

The true and actual consideration for this conveyance is \$0.00.

DATED this 21st day of November, 1995.



MULTNOMAH COUNTY, OREGON

By

Beverly Stein  
BEVERLY STEIN/Chair  
Board of County Commissioners  
for Multnomah County, Oregon

STATE OF OREGON County of Multnomah

SIGNED BEFORE ME November 21, 1995, personally appeared Beverly Stein, who, being sworn, stated that she is the Chair of the Board of County Commissioners of Multnomah County, Oregon, and that this instrument was voluntarily signed in behalf of said county by authority of its Board of County Commissioners. Before me:

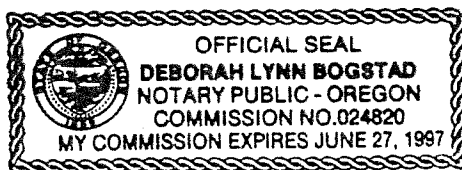

Deborah Lynn Bogstad  
Notary Public for said State

My Commission expires June 27, 1997

REVIEWED:

LAURENCE KRESSEL  
County Counsel  
for Multnomah County, Oregon

By

John L. DuBay  
JOHN L. DuBAY  
Chief Asst. County Counsel

[illegible][illegible]