

In the Matter of the Acceptance of a Deed) ORDER ACCEPTING DEED #88-72
from Gresham Union High School District) TO PROPERTY FOR
No. U2-20 Granting to Multnomah County a) PUBLIC ROAD PURPOSES
perpetual easement for Public Road Purposes)
_____)
N. MAIN AVENUE
Item 88, Parcel 54

As shown on attached map marked Exhibit "A", hereby made a part of this document.

ORDER ACCEPTING DEED
N MAIN AVENUE, Item 88, Parcel 54
Page 2

be accepted by the County and placed of record in the County of Multnomah,
State of Oregon.

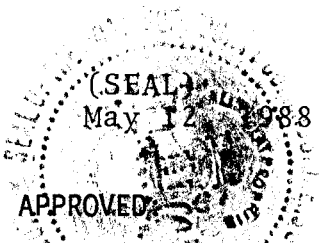

LARRY F. NICHOLAS, P.E.
County Engineer

BOARD OF COUNTY COMMISSIONERS
FOR MULTNOMAH COUNTY, OREGON

Gladys McCoy, Chair

By: R. J. Howard

APPROVED AS TO FORM:

LAURENCE KRESSEL
County Counsel

By: John D. Bay

Deputy

0088W/0611W

(Easement Corporation)
Gresham Union High School Dist. U2-20

N. Main Avenue
(N. of S.E. Division St.)
Item 88-54

KNOW ALL MEN BY THESE PRESENTS, That Gresham Union High School Dist. U2-20 a corporation duly organized and incorporated under the laws of the State of Oregon, in consideration of the sum of: One Dollar, and other valuable consideration to them paid by Multnomah County, a political subdivision of the State of Oregon, have granted and conveyed and by these presents do grant and convey unto said Multnomah County a perpetual easement for the construction and maintenance of a Signal Pole over and within the following described parcel of land:

A parcel of land situated in the southwest one-quarter of Section 3, T1S, R3E, W.M., Multnomah County, Oregon, being more particularly described as follows:

Commencing at the southwest corner of that tract of land conveyed to Gresham Union High School District No. U2-20, by deed recorded October 14, 1965, in Book 400, Page 226, Deed Records of Multnomah County; thence north along the east right of way line of N. Main Avenue., said right of way line lying 30.00 feet (when measured at right angles) east of the center line of said N. Main Avenue., a distance of 11.50 feet to the true point of beginning; thence continuing north along said east right of way line a distance of 3.00 feet; thence east a distance of 3.00 feet; thence south a distance of 3.00 feet; thence west a distance of 3.00 feet to the true point of beginning.

Containing 9 square feet.

As shown on attached map marked Exhibit "A", hereby made a part of this document.

IN WITNESS WHEREOF, N/A

_____ pursuant to a resolution of its Board
of Directors, duly and legally adopted, has caused these presents to be signed by
its _____ President and _____ Secretary, this _____ day
of _____ A.D., 19__.

State of Oregon
County of Multnomah

Signature of ORVAL L. AUSE, signed
and attested before me on 3/21/88
by Shirley K. Schmidt

By Orval L. Ause
~~President~~ Asst. Supt.

~~BY~~ Date: March 21, 1988
Secretary

Commission expires: 3/4/89

Larry F. Nicholas for
LARRY F. NICHOLAS, P. E.
County Engineer

APPROVED AS TO FORM:

LAURENCE KRESSEL
County Counsel

By John DuBay
STATE OF _____)
County of _____) SS

THIS CERTIFIES that on this _____ day of _____ A.D., 19__, before me
appeared _____ and _____, both to
me personally known, who being duly sworn, did say that he, the said _____,
is the _____ President, and he, the said _____, is
the _____ Secretary of the within named Corporation, and that the
said instrument was signed and sealed in behalf of said Corporation by authority of
its Board of Directors, and said _____
and _____, acknowledged said instrument to be the free
act and deed of said Corporation.

IN TESTIMONY WHEREOF, I have hereunto set my hand and affixed my official seal,
this the day and year in this, my certificate written.

Notary Public for Oregon

My Commission expires _____

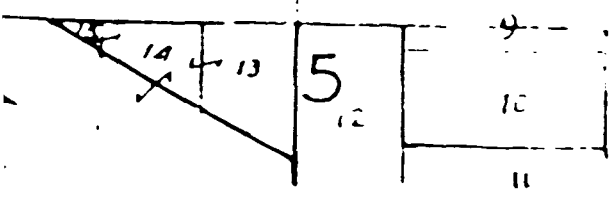
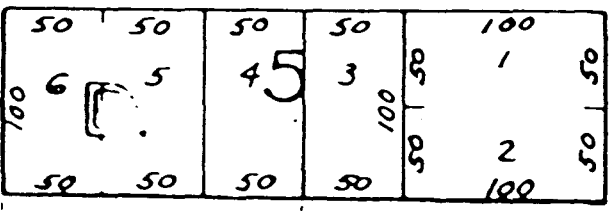
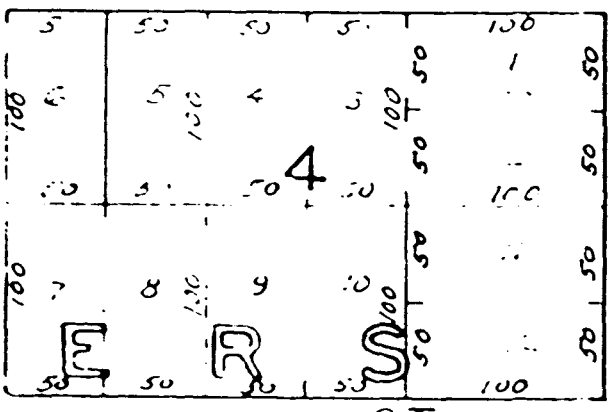
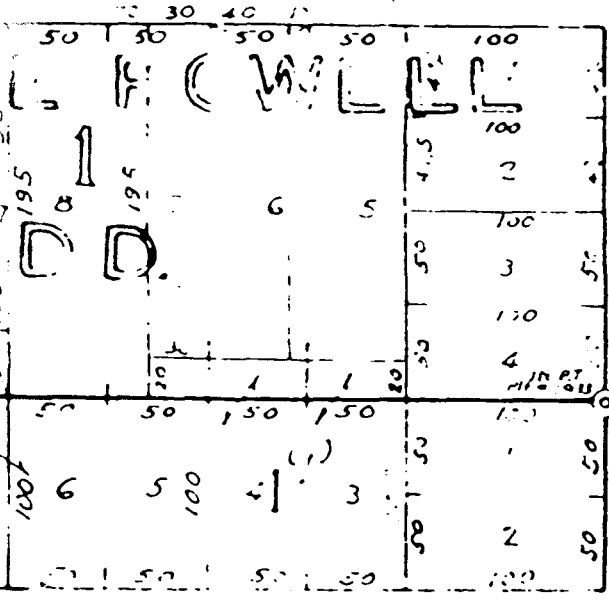
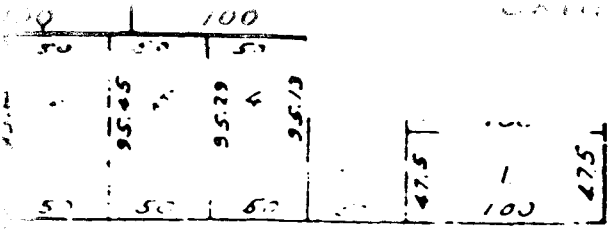

Main Ave.

100 175 18.34

SW. 1/4 Sec. 3
153E

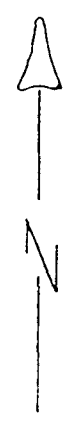

(19)

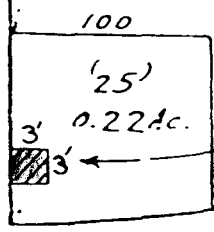

perm easement

Division St.

V F. ROBERTS AVE

map