

Legal Description
Parcel "A"
Edwin Brown Lot Line Adjustment

A tract of land in Section 17, Township 2 North, Range 1 West, of the Willamette Meridian, county of Multnomah, state of Oregon as follows:

Commencing at the initial point of duly recorded plat of "Circus Estates" situate in said section 17, thence S 40° 37'57"W a distance of 31.96' to an angle point in the centerline of Sauvie Island Road, thence N 29°13'00"W along centerline a distance of 352.07' to a railroad spike at Road Angle No. 21 of said Sauvie Island Road, thence continuing along said centerline N 28°45'00"W a distance of 553.95' to a point in the southeasterly line of that certain tract described in Book 896 Page 8 Deed Records, and recorded January 3, 1945, thence S 40° 10'00"W along said southeasterly line a distance of 21.45 feet to a pipe in the southwesterly line of said Sauvie Island Road, and point of beginning of the tract herein to be described: thence S 28°45'00"E along said southwesterly line of road 275.13' to a 5/8" iron rod, thence S 79°22'54"W 73.59' to a 5/8" iron rod, thence S 40° 04'00"W 581.00' to a 5/8" iron rod, thence N 37°33'20"W 216.12' to a 5/8" iron rod set in the southeasterly line of said tract described in Book 896 Page 8 Deed Records, thence N 40° 10'00"E a distance of 691.00' to the point of beginning. Contains an area of 3.31 acres more or less

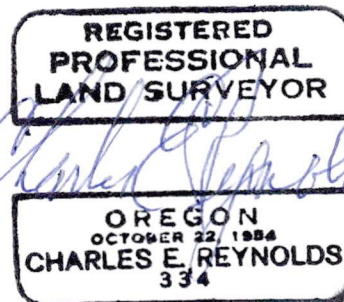
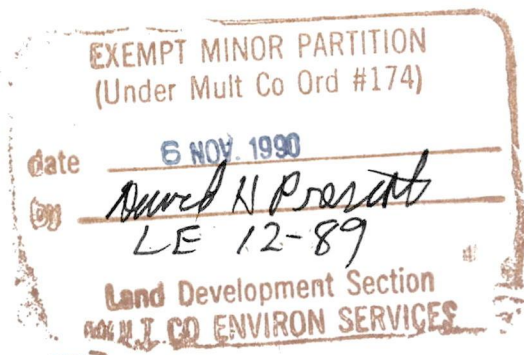

6 NOV. '89

SEC. 17 T 2N R 1W
LE 12-89

Legal Description
Parcel "B"
Edwin Brown Lot Line Adjustment

A tract of land in Section 17, Township 2 North, Range 1 West WM.
County of Multnomah, state of Oregon as follows:

Commencing at the initial point of duly recorded plat of
"Circus Estates" in said section 17 thence S 40°37'57"W
31.96' to an angle point in the centerline of Sauvie Island
Road,,thence along centerline N29°13'00"W 352.07' to a railroad
spike at angle point No. 21 of said road, thence N 28°45'00"W 328.85'
on centerline, thence S 40° 04' 00" W 21.45' to a 3/4"
iron pipe on south boundary of said road, continue on
S 40°04'00"W 75.00' to a 5/8" iron rod which is point of beginning
of tract; thence S40°04'00"W 581.00' to 5/8" iron rod,
thence N37°33'20"W 216.12' to 5/8" iron rod set in the
southeasterly line of that certain tract described in Book
896 page 8 of Deed Records,thence along the southeasterly line
of tract described in Deed Records Book 896 page 8
S 40° 10' 00" W 996.63' to a 3/4" pipe, continue on
S 40°10'00"W 20.0' more or less to lines intersection with the
top of the bank of Willamette Slough, thence along this said
top of the bank run northeasterly 525.' more or less to its
intersection with the southwesterly line of that certain tract
described in Book 1662 page 482 Deed Records,thence along
the southwesterly boundary of tract described in Book1662 page
482 run N 40°04'00"E 10' more or less to 5/8" iron rod,
continue along said tract boundary described in Book1662 page
482 Deed Records N40° 04'00"E 1459.08' to a 3/4" pipe on the
south boundary of Sauvie Island Road, thence along road boundary
N 28° 45' 00" W 271.02' to 5/8" iron rod, thence S79°22'54"W
73.59' to point of beginning. Contains 15.56 acres more or
less.

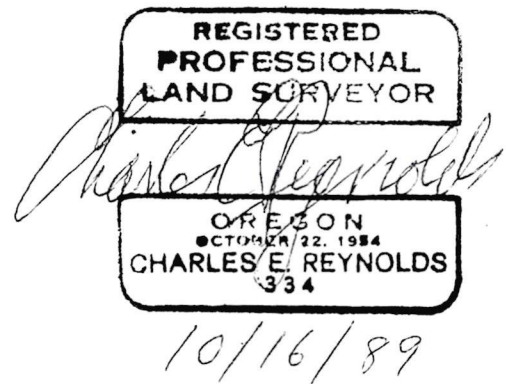
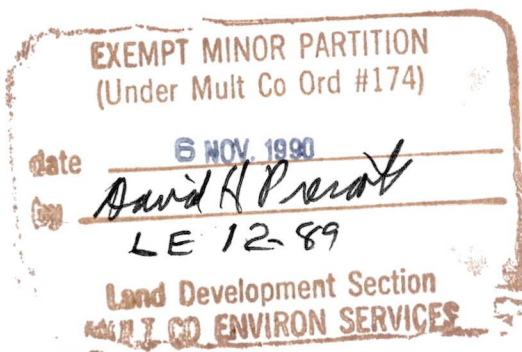

YOUR
COPY

CIRCUS ESTATES

ISLAND

ROAD

BURLINGTON FERRY ROAD

SAUVIE
N 28° 45' 00" W 321.45 MS.
225.00 MS.
225.13 MS.
3/4" I.P.
FD.

100' SE

RR 5th

RR 5th

A
33.31 ac ±
1.1 P

B
15.56 ac ±
1.1 P

T.L.
34
BK 1662 / PP 482

LEGEND

- CORNER MONUMENTS FOUND
- SET 5/8" 30" IRON ROD WITH PLASTIC CAP STAMPED "C REYNOLDS 334"

REGISTERED
PROFESSIONAL
LAND SURVEYOR
Charles E. Reynolds
OREGON
135

BASIS OF BEARINGS
"PLAT OF CIRCUS ESTATES"

NARRATIVE: BASED ON
RS 10.47562. FOUND
THREE POINTS SET IN THIS
SURVEY ALONG SAUVIE ISLAND
ROAD AND SET LOT LINE
CHANGE

6 NOV 1990
EXEMPT MINOR PARTITION
(Under Mult Co Ord #174)
MAY 11 1989
LE 11-89
Land Development Section
MULTI CO ENVIRON SERVICES

SURVEY for LOT LINE ADJUSTMENT

T.L.S 13 & 23

DATE	CLIENT	SECTION	SURVEYOR
10/16/89	Charles E. Reynolds	17.211, R 114 W 11 N	Charles E. Reynolds
10/16/89	Charles E. Reynolds	Multnomah Co. Ore.	Charles E. Reynolds
10/16/89	Charles E. Reynolds	SAUVIE ISLAND	Charles E. Reynolds

