

**MULTNOMAH COUNTY BOARD OF COMMISSIONERS
PUBLIC TESTIMONY SIGN-UP**

Please complete this form and return to the Board Clerk

This form is a public record

MEETING DATE: 20th Feb 18 THU

SUBJECT: PROJECT LIS

0930

AGENDA NUMBER OR TOPIC: COMMENT

FOR: _____ AGAINST: _____ THE ABOVE AGENDA ITEM

NAME: CHARLES ORMSBY

65KIP

ADDRESS: CLACKAMAS COUNTY

1710 SW BIRDSEHILL ROAD

CITY/STATE/ZIP: PORTLAND

OR

97219-8502

PHONE: _____

DAYS: _____

EVE: 503.636.4483

EMAIL: sentinel@skip@gmail.com

FAX: _____

WRITTEN TESTIMONY: _____

Yes

IF YOU WISH TO ADDRESS THE BOARD:

1. Please complete this form and return to the Board Clerk.
2. Address the County Commissioners from the presenter table microphones. Please limit your comments to **3 minutes**.
3. State your name for the official record.
4. If written documentation is presented, please furnish one copy to the Board Clerk.

IF YOU WISH TO SUBMIT WRITTEN COMMENTS TO THE BOARD:

1. Please complete this form and return to the Board Clerk.
2. Written testimony will be entered into the official record.

Request to Identify Projects and Initiatives wrt Birdshill CPO / NA Locale

2011 Feb 02 Wednesday 13:00 U [1:00 PM PT]



Initiated By:
Acting Chair of the
Birdshill CPO / NA

Birdshill CPO / NA
of Clackamas County (CPO –
Community Planning Organization)
and City of Lake Oswego Oregon
(NA – Neighborhood Association)

2009 – 2010 Officers
Acting Chair: Charles Ormsby
Sec / Treas: John Hedlund

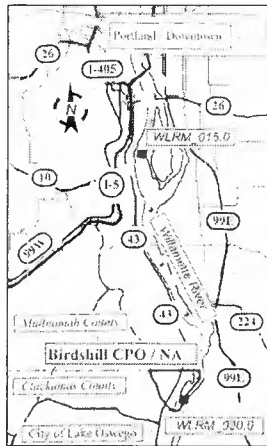

Location:
The Birdshill CPO / NA (area)
is a joint county and city
community located on the west
bank of the Willamette River
between river miles 019.4
south to 020.2. This is about
seven miles south of central
Portland Oregon and
immediately north of the City
of Lake Oswego Oregon in
Clackamas County.

Google Earth Coordinates
Intersect: Underhill / Midvale Rds
045° 25' 46.65" N,
122° 39' 39.90" W

Contact Information Birdshill CPO/NA Acting Chair:

Phone: 503.636.4483 Residence
Mail: Clackamas County – Birdshill Area
170 SW Birdshill Road
Portland OR 97219-8052

Internet Presence – Birdshill CPO / NA

Email: sentinelskip@gmail.com (Please Use)
Email: birdshillcpona@gmail.com
Website: <http://sites.google.com/site/birdshillcpona>
Group: <http://group.google.com/group/birdshillcpona>
YouTube: <http://www.youtube.com/birdshillcpona>

Attached Files / Cross Referenced Files:

05 – World of Documents Referred to & Hyperlinked
Detail levels, pages, document files and disk space:

Detail Level	No Pages	No Files	Cum Disk Spc [kb-kilobytes]
L1 – Abstract:	2	1	300 kb
L2– Summary:	0	0	0 kb
L3 – Key Docs:	14	2	700 kb
L4 – Total Outline:	0	0	0 kb
L6 – World of Docs:	16	3	1,000 kb

Notes on referenced documents:

1. Files referenced have been posted to above website for download.
2. **Downloaded files require name change to enable hyperlinks**
3. Files available for at least 30 days from date at top of column.
4. Files also available upon request by email to above address(es)

GLOSSARY & Terms – See spreadsheet: Edition Access

Website: <https://sites.google.com/site/or43data01/home/bhdocsalt>

Edition: L1 – Abstract (Only Edition)

**Edition Access: L1 – Abstract, L2 – Summary,
L3 – Key Documents, and L4 – Total Outline**

Website for editions: <https://sites.google.com/site/or43data01/home/bhdocsalt>

Note: Navigate between most headers by Ctrl + mouse click, to follow most links

Note: CR = Cross Reference – Linked jump to Outline Section & then to endnotes

Affected Parties(s):

Government Levels wrt Birdshill CPO / NA Locale

1. Lev 100 = Federal – Army Core of Engineers and undetermined entities.
2. Lev 080 = State of Oregon – ODOT, TriMet and undetermined entities.
3. Lev 070 = Regional – Metro (Oregon Metro)
4. Lev 060 = County – County of Clackamas and County of Multnomah
5. Lev 050 = Municipal – City of Lake Oswego and City of Portland.
6. Lev nnn = Service Providers – PGE, NW Natural, Quest, Service Districts

01 – Abstract of Request

Birdshill CPO / NA Bylaws require the annual compilation of a list of projects and initiatives that affect the locale of our community. This request initiates this compilation and process of annual review along with requests of government entities with jurisdiction in and around the area of the Birdshill CPO / NA. That the government entities identify, label, delineate, and describe ALL projects and initiatives that may affect the area of the Birdshill CPO / NA and immediate locale along with residents. Two items in this process are most important: First is a contact, with phone, and email services that have both current and historical knowledge of the project or initiative. Second are methods to trace the project or initiative to source documents that can be monitored over time. The attached maps on the next page identify the locale and regional context.

02 – Summary of Documents & Impact

Birdshill CPO / NA Bylaws Ver 6.09,
Ratified by Membership: 2009 Mar 18 Wednesday
Approved by Clackamas County: 2009 Jun 16 Tuesday
Approved by City of Lake Oswego: 2009 Jul 21 Tuesday

“Article II – Principles of Operation

Section 4 – Issues and Consultation With Members

In order to assure early and continued public involvement. With adequate time for citizen notification, study, and formulation of actions in all aspects of participation in governance that may affect both the area and residents of the Birdshill CPO / NA. The Board shall:

1. *Communicate with leaders at multiple levels of governance, community groups, and area service providers and ascertain what issues that may consist of projects, programs, and initiatives that will affect the area of the Birdshill CPO / NA and members within the coming year.*
2. *Develop an Annual Report itemizing, identifying, labeling, delineating, and describing in summary form items ascertained in item 1 above.*
3. *Deliver or make available the Annual Report developed in item 2 above to the membership of the Birdshill CPO / NA, no later than the Monday following Labor Day each year.*
4. *Consult with the membership before making recommendations about neighborhood improvements.”*

03 – Key Documents

03.01 Birdshill CPO / NA Bylaws

Site: <http://www.ci.oswego.or.us/plan/Neighborhoods/default.htm>
File: [BYLW_BHCN_RTFD_0609_2009_04Apr_30Th_0900U.pdf](#)

03.02 Birdshill CPO / NA Schema of Government Levels

Site: <https://sites.google.com/site/or43data01/home/bhdocsalt>
File: [LIST_BHCN_Scheme_Gov_Lev_2011_02Feb_01Tu_1500U.pdf](#)

04 – Total Outline of Documents

No documents outlined.

05 – World of Documents Referred to & Hyperlinked

See Section 03 – Key Documents above.

Birdshill CPO / NA Locale

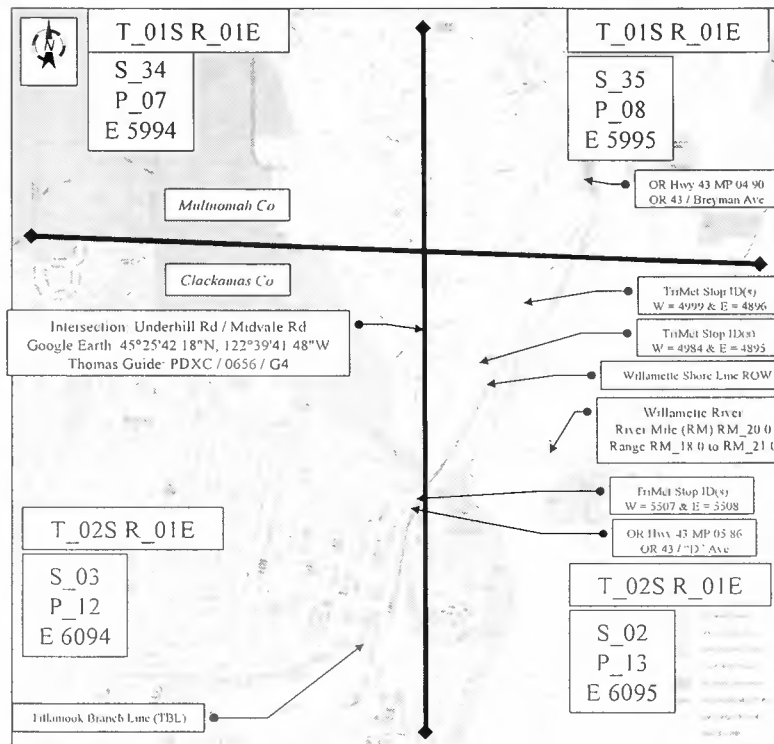

Area of Project / Initiatives wrt Birdshill CPO / NA

Date: 2011 Feb 02 Wednesday 13 00 U (1 00 PM PT)

Author: Charles Ormsby (Skip)

Email: orsentinel@skip@gmail.com

Source:

Cut: 151% h = 30.09 in w = 31.06 in

Paste: 22% h = 6.56 in w = 6.67 in

Birdshill CPO / NA and Regional Context

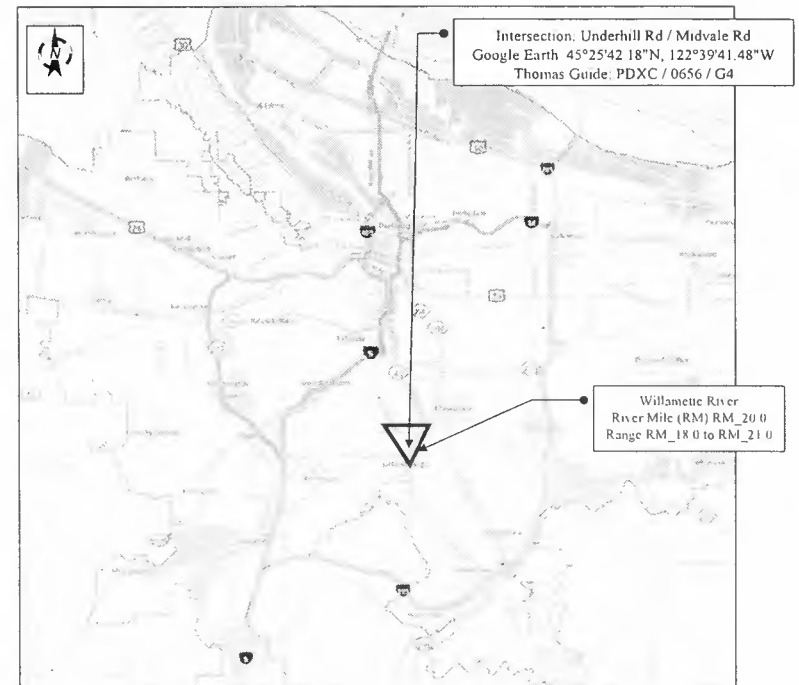

Regional Context of Project / Initiatives wrt Birdshill CPO / NA

Township 01S, Range: 01E, Sections 34 and 35

Township 02S, Range: 01E, Sections 02 and 03

Date: 2011 Feb 02 Wednesday 13 00 U (1 00 PM PT)

Author: Charles Ormsby (Skip)

Email: orsentinel@skip@gmail.com

Source: Metro 2035 RTP (Regional Transportation Plan)

page 41 of 141, Figure 5 Map of the Portland region and TSM (Transportation System Management) investments in 2000

Cut: 200% h = 19.35 in w = 19.97 in

Paste: 22% h = 6.04 in w = 6.23 in