

ALLAN & LEUTHOLD, INC.  
SURVEYING  
4827 N. E. 105th AVENUE  
PORTLAND, OREGON 97220  
503 - 254-0734

PARCEL # 1

Portions of lots 5 & 6 Block 6 DAGMAR ACRES in the S.W.  $\frac{1}{4}$  of Section 2  
T. 1 S., R. 2 E., W.M. Multnomah County, Oregon described as follows:

Beginning at a point on the North line of S.E. Lincoln St. as now  
established, said point being North  $0^{\circ} 34' 30''$  East 5.00 feet from the Southeast  
corner of lot 6 Block 6 Dagmar Acres; thence North  $88^{\circ} 50'$  West along the North  
line of S.E. Lincoln St. a distance of 58.40 feet; thence North  $0^{\circ} 34' 30''$  East  
parallel to the East line of said lot 6 a distance of 145.78 feet; thence  
South  $88^{\circ} 50'$  East parallel to the South line of said lot 6 a distance of  
58.40 feet to a point in the East line of said lot; thence South  $0^{\circ} 34' 30''$   
West along the East line of said lot a distance of 145.78 feet to the point  
of beginning...

Containing 8513 sq. ft. more or less...

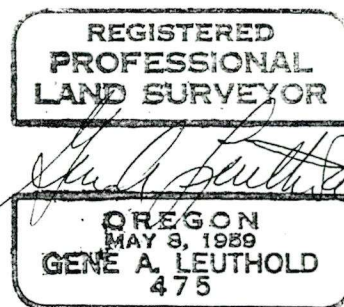
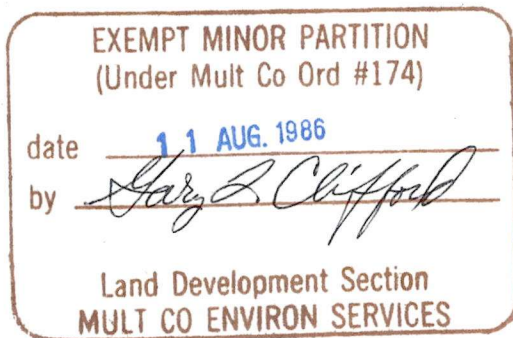

11 AUG 86

3243

ALLAN & LEUTHOLD, INC.  
SURVEYING  
4827 N. E. 105th AVENUE  
PORTLAND, OREGON 97220  
503 - 254-0734

PARCEL # 2

Portions of lots 5 & 6 Block 6 DAGMAR ACRES in the S.W.  $\frac{1}{4}$  of Section 2  
T. 1 S., R. 2 E., W.M. Multnomah County, Oregon described as follows:

Beginning at a point on the North line of S.E. Lincoln St. as now  
established, said point being North  $0^{\circ} 34' 30''$  East 5.00 feet and North  $88^{\circ} 50'$   
West 58.40 feet from the Southeast corner of lot 6 Block 6 Dagmar Acres; thence  
continuing North  $88^{\circ} 50'$  West along the North line of S.E. Lincoln St. a  
distance of 58.40 feet; thence North  $0^{\circ} 34' 30''$  East parallel to the East  
line of lot 6 a distance of 145.78 feet; thence South  $88^{\circ} 50'$  East parallel  
to the South line of said lot 6 a distance of 58.40 feet to a point that is  
North  $88^{\circ} 50'$  West 58.40 feet from the East line of said lot; thence South  
 $0^{\circ} 34' 30''$  West parallel to the East line of lot 6 a distance of 145.78 feet  
to the point of beginning..

Containing 8513 sq. ft. more or less....

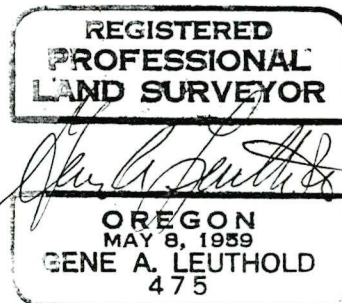
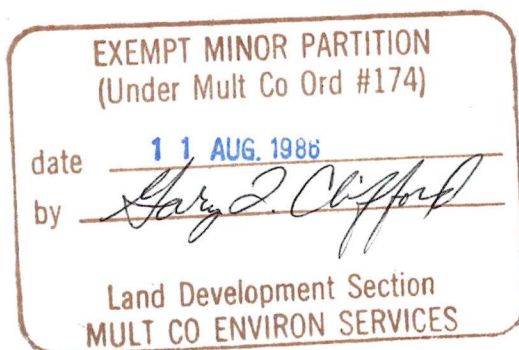

ALLAN & LEUTHOLD, INC.  
SURVEYING  
4827 N. E. 105th AVENUE  
PORTLAND, OREGON 97220  
503 - 254-0734

PARCEL # 3

Portions of lots 5 & 6 Block 6 DAGMAR ACRES in the S.W.  $\frac{1}{4}$  of Section 2  
T. 1 S., R. 2 E., W.M. Multnomah County, Oregon described as follows:

Beginning at a point on the North line of S. E. Lincoln St. as now  
established, said point being North  $0^{\circ} 34' 30''$  East 5.00 feet and North  $88^{\circ} 50'$   
West 116.80 feet from the Southeast corner of lot 6 Block 6 Dagmar Acres;  
thence continuing along said North line North  $88^{\circ} 50'$  West a distance of  
182.41 feet to the East line of S.E. 130th Ave.; thence North  $0^{\circ} 34' 30''$  East  
along the East line of S.E. 130th Ave. a distance of 145.78 feet; thence  
South  $88^{\circ} 50'$  East parallel to the South line of lot 6 a distance of 182.41 feet  
to a point that is North  $88^{\circ} 50'$  West 116.80 feet from the East line of said  
lot 6; thence South  $0^{\circ} 34' 30''$  West parallel to the East line of said lot 6  
a distance of 145.78 feet to the point of beginning..

Containing 26,592 sq. ft. more or less...

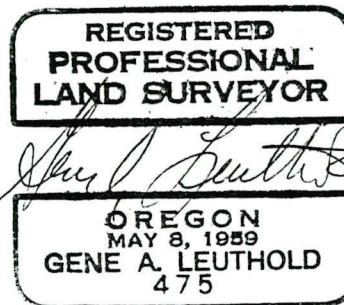
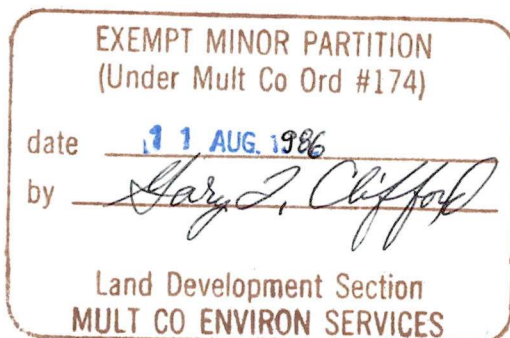



NORTH

S.E. 130th AVE.

Fnd R.R. Spike

S.E. MILL ST.

Fnd 2" I. Pipe

REFERENCE SURVEYS

24331, 42113, 43307, 45851

PLAT - DAGMAR ACRES

LEGEND

5248 34 35.00 BC

- DENOTES: Set 5/8" X 30" Iron Rod
- DENOTES: Found Iron as indicated
- ✱ DENOTES: Found Brass Screw

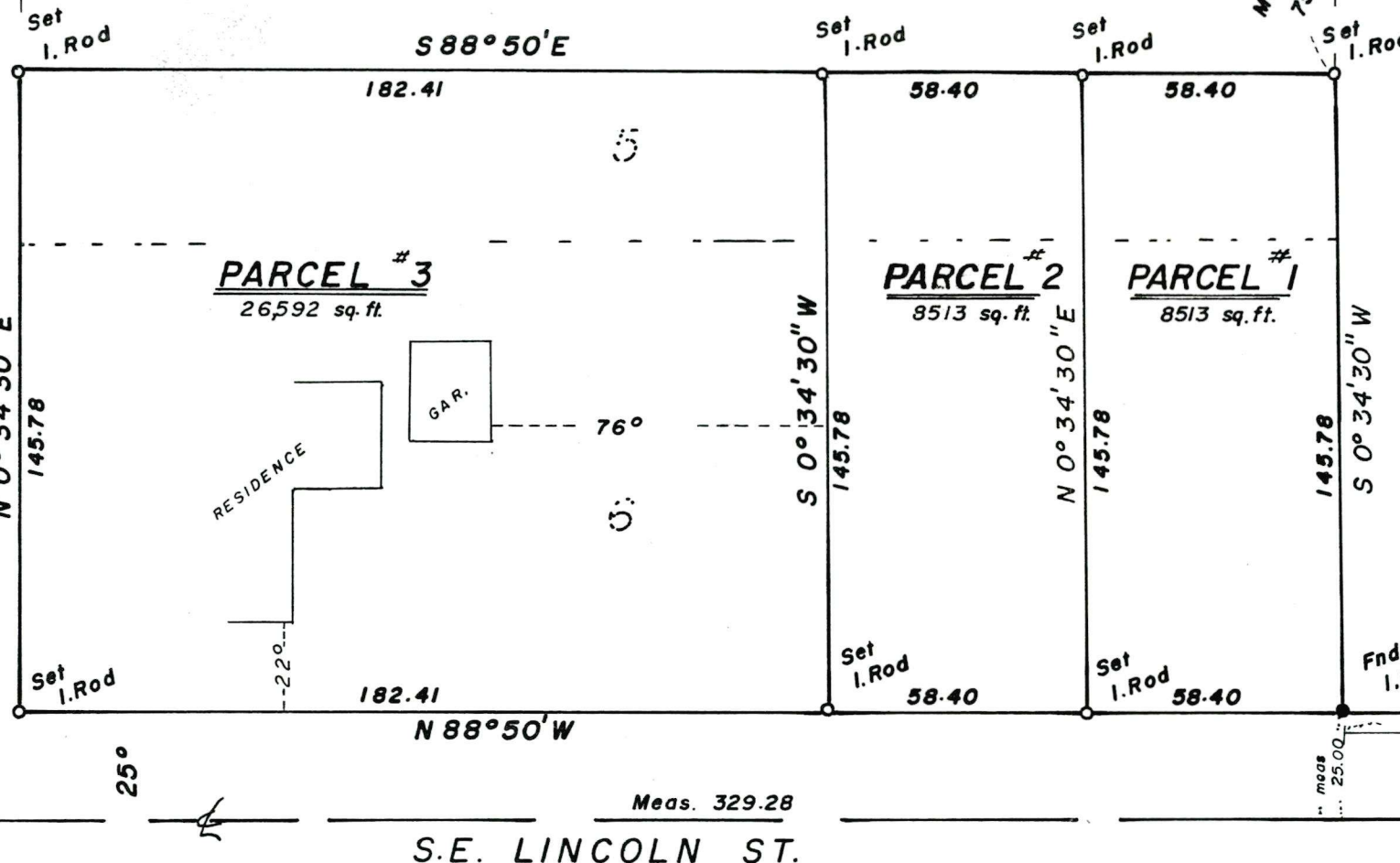

# CERTIFICATE of SURVEY

OF LOT 6 & PORTION OF LOT 5

BLOCK 6 DAGMAR ACRES

S.W. 1/4 Section 2 T.1S, R.2E

Multnomah County,

Oregon

Scale: 1" = 40'

July 30, 1986

ALLAN & LEUTHOLD, INC.  
SURVEYING  
4827 N. E. 103th AVENUE  
PORTLAND, OREGON 97220  
503 - 254-0734

## NARRATIVE:

Purpose of survey to perform a Exempt Minor Partition on the property. Began survey at the intersection of S.E. 130th and S.E. Lincoln St. using a found R.R. Spike at this point. Turned angle from R.R. Spikes in S.E. 130th to found points along the North line of S.E. Lincoln St. measured to centerline. Measured East from S.E. 130th to found points shown.

Held plat distance and field angle to set irons for new lots.

Basis of bearings found R.R. Spikes in S.E. 130th Ave.

Bearings from reference surveys in Dagmar Acres.

Set 5/8" x 30" iron rods with plastic cap marked L.S. 475...

EXEMPT MINOR PARTITION  
(Under Mult Co Ord #174)

date 11 AUG. 1986

by Gary S. Clifford

Land Development Section  
MULT CO ENVIRON SERVICES

ALLAN & LEUTHOLD, INC.  
SURVEYING  
4827 N. E. 105th AVENUE  
PORTLAND, OREGON 97220  
503 - 254-0734

BOOK 1928 PAGE 661

PARCEL # 1

Portions of lots 5 & 6 Block 6 DAGMAR ACRES in the S.W.  $\frac{1}{4}$  of Section 2  
T. 1 S., R. 2 E., W.M. Multnomah County, Oregon described as follows:

Beginning at a point on the North line of S.E. Lincoln St. as now  
established, said point being North  $0^{\circ} 34' 30''$  East 5.00 feet from the Southeast  
corner of lot 6 Block 6 Dagmar Acres; thence North  $88^{\circ} 50'$  West along the North  
line of S.E. Lincoln St. a distance of 58.40 feet; thence North  $0^{\circ} 34' 30''$  East  
parallel to the East line of said lot 6 a distance of 145.78 feet; thence  
South  $88^{\circ} 50'$  East parallel to the South line of said lot 6 a distance of  
58.40 feet to a point in the East line of said lot; thence South  $0^{\circ} 34' 30''$   
West along the East line of said lot a distance of 145.78 feet to the point  
of beginning...

Containing 8513 sq. ft. more or less...

EXEMPT MINOR PARTITION  
(Under Mult Co Ord #174)

date 11 AUG. 1986

by Gary A. Clifford

Land Development Section  
MULT CO ENVIRON SERVICES

REGISTERED  
PROFESSIONAL  
LAND SURVEYOR

*Gene A. Leuthold*  
OREGON  
MAY 8, 1989  
GENE A. LEUTHOLD  
475

Multnomah County Oregon  
Division of Assessment & Taxation  
610 S.W Alder, Room 320  
Portland, Oregon 97205-3603

728-12 SC

PARCEL # 2

Portions of lots 5 & 6 Block 6 DAGMAR ACRES in the S.W.  $\frac{1}{4}$  of Section 2  
T. 1 S., R. 2 E., W.M. Multnomah County, Oregon described as follows:

Beginning at a point on the North line of S.E. Lincoln St. as now  
established, said point being North  $0^{\circ} 34' 30''$  East 5.00 feet and North  $88^{\circ} 50'$   
West 58.40 feet from the Southeast corner of lot 6 Block 6 Dagmar Acres; thence  
continuing North  $88^{\circ} 50'$  West along the North line of S.E. Lincoln St. a  
distance of 58.40 feet; thence North  $0^{\circ} 34' 30''$  East parallel to the East  
line of lot 6 a distance of 145.78 feet; thence South  $88^{\circ} 50'$  East parallel  
to the South line of said lot 6 a distance of 58.40 feet to a point that is  
North  $88^{\circ} 50'$  West 58.40 feet from the East line of said lot; thence South  
 $0^{\circ} 34' 30''$  West parallel to the East line of lot 6 a distance of 145.78 feet  
to the point of beginning..

Containing 8513 sq. ft. more or less....

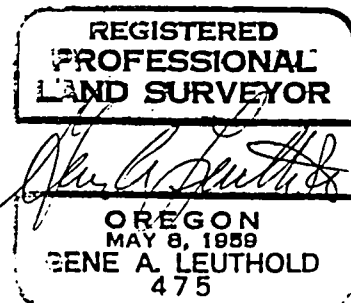
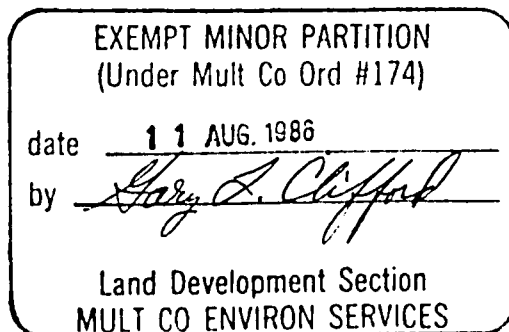

Multnomah County Oregon  
Division of Assessment & Taxation  
610 S.W Alder, Room 320  
Portland, Oregon 97205-3603

*ju 8-12-86*

PARCEL # 3

Portions of lots 5 & 6 Block 6 DAGMAR ACRES in the S.W.  $\frac{1}{4}$  of Section 2  
T. 1 S., R. 2 E., W.M. Multnomah County, Oregon described as follows:

Beginning at a point on the North line of S. E. Lincoln St. as now  
established, said point being North  $0^{\circ} 34' 30''$  East 5.00 feet and North  $88^{\circ} 50'$   
West 116.80 feet from the Southeast corner of lot 6 Block 6 Dagmar Acres;  
thence continuing along said North line North  $88^{\circ} 50'$  West a distance of  
182.41 feet to the East line of S.E. 130th Ave.; thence North  $0^{\circ} 34' 30''$  East  
along the East line of S.E. 130th Ave. a distance of 145.78 feet; thence  
South  $88^{\circ} 50'$  East parallel to the South line of lot 6 a distance of 182.41 feet  
to a point that is North  $88^{\circ} 50'$  West 116.80 feet from the East line of said  
lot 6; thence South  $0^{\circ} 34' 30''$  West parallel to the East line of said lot 6  
a distance of 145.78 feet to the point of beginning..

Containing 26,592 sq. ft. more or less...

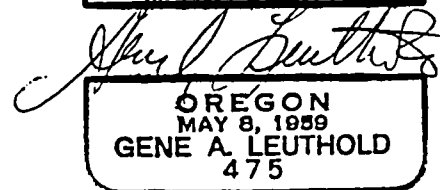
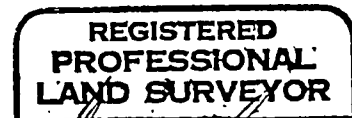
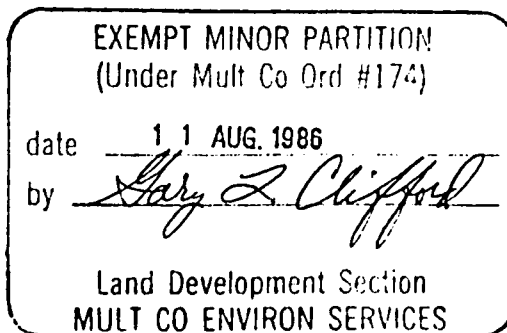

Multnomah County Oregon  
Division of Assessment & Taxation  
610 S.W. Alder, Room 320  
Portland, Oregon 97205-3603

72/8-12-86

NORTH

S.E. 130th AVE.

S.E. MILL ST.

S 88° 50' E

182.41

PARCEL #2  
8513 sq. ft.

PARCEL #1  
8513 sq. ft.

PARCEL #3  
26592 sq. ft.

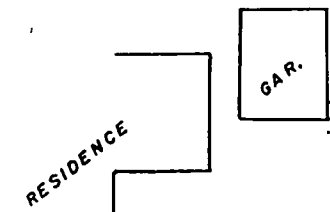

RESIDENCE

GAR.

76°

N 88° 50' W

S.E. LINCOLN ST.

REFERENCE SURVEYS

24331, 42113, 43307, 45851  
PLAT - DAGMAR ACRES

LEGEND

- DENOTES: Set 5/8" X 30" Iron Rod
- DENOTES: Found Iron as Indicated
- ✦ DENOTES: Found Brass Screw

NARRATIVE:

Purpose of survey to perform an Exempt Minor Partition on the property. Began survey at the intersection of S.E. 130th and S.E. Lincoln St. using a found R.R. Spike at this point. Turned angle from R.R. Spikes in S.E. 130th to found points along the North line of S.E. Lincoln St. measured to centerline. Measured East from S.E. 130th to found points shown.

Held plat distance and field angle to set irons for new lots.  
Basis of bearings found R.R. Spikes in S.E. 130th Ave.  
Bearings from reference surveys in Dagmar Acres.  
Set 5/8" x 30" iron rods with plastic cap marked L.S. 475...

**CERTIFICATE of SURVEY**  
**OF LOT 6 & PORTION OF LOT 5**  
**BLOCK 6 DAGMAR ACRES**

S.W. 1/4 Section 2 T.1S, R.2E

Multnomah County, Oregon

Scale: 1" = 40' July 30, 1986

ALLAN & LEUTHOLD, INC.  
SURVEYING  
4827 N. E. 105th AVENUE  
PORTLAND, OREGON 97220  
503 - 254-0734

REGISTERED  
PROFESSIONAL  
LAND SURVEYOR  
  
OREGON  
MAY 8, 1989  
GENE A. LEUTHOLD  
475

EXEMPT MINOR PARTITION  
(Under Mult Co Ord #174)  
date 11 AUG. 1986  
by *Gary J. Clifford*  
Land Development Section  
MULT CO ENVIRON SERVICES

Multnomah County Oregon  
Division of Assessment & Taxation  
610 S.W Alder, Room 320  
Portland, Oregon 97205-3603



I, a Deputy for the Recorder of Conveyances, in and for said County, do hereby certify that the within instrument of writing was received for record and recorded in the record of said County

1986 AUG 12 PM 1:55

RECORDING SECTION  
MULTNOMAH CO. OREGON

**In Book**  
**BOOK 1928**

witness my hand and seal of office affixed.

## Recorder of Conveyances

N. Waller Deputy

OWNER - MONTGOMERY CONTRACTING INC  
P.O. BOX 673  
FRESHMAN ORLA 97030

Return to -

21%