

ALLAN & LEUTHOLD, INC.  
SURVEYING  
4827 N. E. 105th AVENUE  
PORTLAND, OREGON 97220  
503 - 254-0734

PARCEL #1

A tract of land in Sections 1 and 12 T. 1 S., R. 4 E., W.M. Multnomah County, Oregon described as follows:

Beginning at a point that is South  $0^{\circ} 20' 50''$  West 200.00 feet and North  $87^{\circ} 36' 05''$  West 851.50 feet from the Northeast corner of Section 12; thence North  $87^{\circ} 36' 05''$  West 462.69 feet; thence North  $2^{\circ} 20' 40''$  West 698.27 feet; thence North  $74^{\circ} 54' 30''$  East 335.34 feet to a point in the southerly right of way line of Loudon Road; thence along said southerly right of way South  $24^{\circ} 48'$  East 153.68 feet to a point of curve; thence on the arc of a 180.80 foot radius curve to the left (the chord of which bears South  $67^{\circ} 00'$  East 242.89 feet) a distance of 266.33 feet to a point of tangency; thence North  $70^{\circ} 48'$  East along said right of way a distance of 166.71 feet to a point of curve; thence on the arc of a 447.50 foot radius curve to the right (the chord of which bears South  $85^{\circ} 04'$  East 365.93 feet) a distance of 376.98 feet to a point of tangency; thence South  $60^{\circ} 58'$  East along said right of way 141.87 feet to a point of curve; thence on the arc of a 507.50 foot radius curve to the left (the chord of which bears South  $62^{\circ} 48' 20''$  East 32.57 feet) a distance of 32.57 feet; thence leaving said right of way South  $0^{\circ} 39' 30''$  West 270.00 feet; thence North  $76^{\circ} 07' 30''$  West 230.49 feet; thence South  $39^{\circ} 53'$  West 150.00 feet; thence North  $87^{\circ} 36' 05''$  West 481.50 feet; thence South  $2^{\circ} 20' 40''$  East 200.00 feet to the point of beginning...

Containing 644,311 sq. ft. or 14.79 acres more or less..

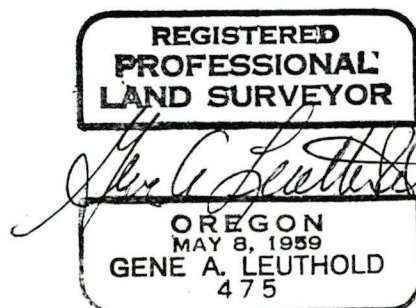
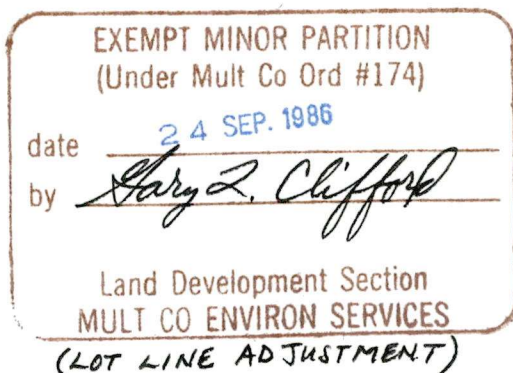

24 SEP 1986

Sec. 1 & 12, T. 1 S., R. 4 E.

ALLAN & LEUTHOLD, INC.  
SURVEYING  
4827 N. E. 105th AVENUE  
PORTLAND, OREGON 97220  
503 - 254-0734

PARCEL # 2

A tract of land in Sections 1 and 12 T. 1 S., R. 4 E., W.M. Multnomah County, Oregon described as follows:

Beginning at the Northeast corner of Section 12; thence South  $0^{\circ} 20' 50''$  West along the East line of said Section a distance of 200.00 feet; thence North  $87^{\circ} 36' 05''$  West parallel to the North line of Section 12 a distance of 851.50 feet; thence North  $2^{\circ} 20' 40''$  West 200.00 feet; thence South  $87^{\circ} 36' 05''$  East 481.50 feet; thence North  $39^{\circ} 53'$  East 150.00 feet; thence South  $76^{\circ} 07' 30''$  East 230.49 feet; thence North  $0^{\circ} 39' 30''$  East 270.00 feet to a point in the Southerly right of way line of Loudon Road; thence on the arc of a 507.50 feet radius curve to the left (the chord of which bears South  $68^{\circ} 14' 34''$  East 64.29 feet) a distance of 64.33 feet to a point in the East line of Section 1; thence South  $0^{\circ} 39' 30''$  West along said East line a distance of 321.20 feet to the Southeast corner of said Section 1 and the point of beginning

Containing 217,850 sq. ft. or 5.00 acres more or less..

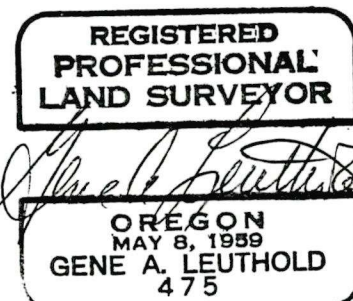
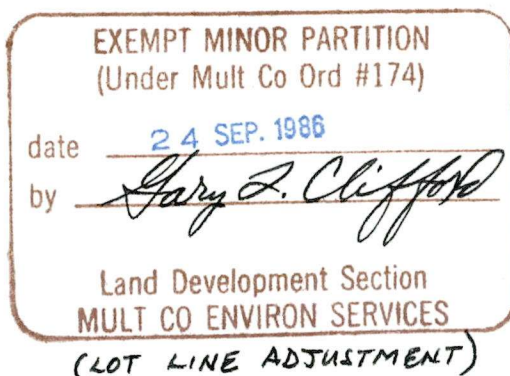



EXEMPT MINOR PARTITION  
(Under Mult Co Ord #174)  
date 24 SEP. 1986  
by Gary L. Clifford  
Land Development Section  
MULT CO ENVIRON SERVICES

NARRATIVE:

Purpose of survey to adjust lot lines between two tracts.

Began survey at the Section corner common to Sections 1,6,7, & 12 and ran random to Louden Road. Tied found points in the center of Louden Road and found irons as shown. Section line location from reference surveys. Set irons as directed to adjust lines of parcels as shown

Basis of bearings found centerline R.R. Spikes in Louden Road.

Bearings from Co. read datum on Louden Road.. Set 5/8" x 30" iron rods with plastic Cap marked L.S. 475

REGISTERED  
PROFESSIONAL  
LAND SURVEYOR  
OREGON  
MAY 8, 1989  
GENE A. LEUTHOLD  
475

CERTIFICATE of SURVEY  
Of A Tract

Sections 1 & 12 T1S, R4E  
Multnomah County, Oregon

Scale: 1" = 100 Sept. 11, 1986

ALLAN & LEUTHOLD, INC.  
SURVEYING  
4827 N. E. 105th AVENUE  
PORTLAND, OREGON 97220  
503 - 254-0734

REFERENCE SURVEYS  
30430, 34117, 34308,  
26724, 34900

LEGEND

- o DENOTES: set 5/8" x 30" iron rod
- DENOTES: found iron as indicated

PARCEL 1  
644,311 sq. ft.  
14.79 Acres

PARCEL 2  
217,850 sq. ft.  
5 ACRES

