

LOT LINE ADJUSTMENT  
FOR  
LARRY OLSON & LONGVIEW FIBRE

LEGAL DESCRIPTION  
August 28, 1991  
Page 1 of 2

TRACT 1

Beginning at a brass cap set in concrete at the Quarter corner to Sections 11 and 14, T2N, R2W, W.M., Multnomah County, Oregon; thence along the section line N 87°01'34" W 1676.21 feet to a 5/8" iron rod on the easterly right-of-way line of Skyline Boulevard; thence along said right-of-way line by the following courses, leaving said section line, along the arc of a 447.50 foot radius curve left (long chord: S 23°14'07" E 264.81 feet) 268.84 feet; thence S 40°16'26" E 64.96 feet to a 3/4" iron pipe; thence along the arc of a 507.50 foot radius curve right (long chord: S 23°48'40" E 291.57 feet) 295.73 feet; thence S 6°57'00" E 1191.93 feet; thence along the arc of a 686.30 foot radius curve left (long chord: S 32°14'56" E 586.45 feet) 605.94 feet to a 3/4" iron pipe; thence S 57°33'04" E 422.01 feet to a 5/8" iron rod on the west line of that tract conveyed to Walter S. Hershey, et ux, per Book 1680, Page 515, said Deed Records; thence leaving said right-of-way line along the Hershey west line N 0°38'10" W 427.46 feet to a 5/8" iron rod at the northwest corner thereof; thence along the Hershey north line S 87°32'50" E 624.00 feet to a 5/8" iron rod at the northeast corner thereof, lying on the north-south centerline of said Section 14; thence continuing S 87°32'50" E 644.39 feet to a 5/8" iron rod; thence N 0°38'10" W 677.38 feet to a 5/8" iron rod on the east-west centerline of the Northeast 1/4 of said Section 14; thence along said east-west centerline N 87°37'11" W 644.35 feet to a 3/4" iron pipe at the Center-North 1/16 corner of said Section; thence N 0°38'48" W 1300.86 feet to the point of beginning; containing 76.52 acres, more or less.

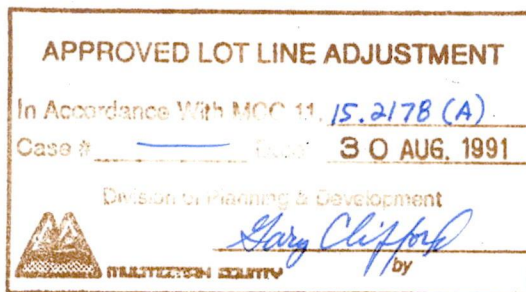

30 AUG '91

14 2N 2W

Lot Line Adjustment for  
Larry Olson/Longview Fibre  
Legal Description  
August 28, 1991  
Page 2 of 2

TRACT 2

A portion of the South 1/2 of the Northeast 1/4 of Section 14,  
T2N, R2W, W.M., Multnomah County, Oregon, being described as  
follows:

Beginning at a brass cap set in concrete at the Center quarter of  
said section, being also the southeast corner of that certain  
tract conveyed to Walter S. Hershey, et ux, per Book 1680, Page  
515, Deed Records of Multnomah County; thence along the  
north-south centerline of said section N 0°38'10" W 624.00 feet  
to a 5/8" iron rod at the northeast corner of said Hershey tract;  
thence leaving said north-south centerline S 87°32'50" E 644.39  
feet to a 5/8" iron rod; thence N 0°38'10" W 677.38 feet to a  
5/8" iron rod on the east-west centerline of the Northeast 1/4 of  
said Section 14; thence along said east-west centerline S 87°  
37'11" E 2052.48 feet to a 3/4" iron pipe at the North 1/16  
corner between Sections 13 and 14, said township and range;  
thence along the section line, by the following course per  
Multnomah County Survey No. 11869, S 1°56'04" E 1300.53 feet to  
the Quarter corner between said Sections 13 and 14; thence along  
the east-west centerline of said Section 14, by the following  
course per said County Survey, N 88°10'10" W 2719.50 feet to the  
point of beginning; containing 70.6 acres, more or less.

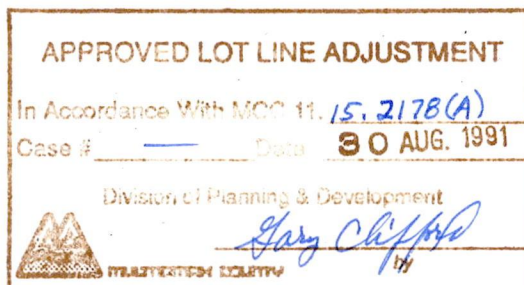



# MULTNOMAH COUNTY OREGON

DEPARTMENT OF ENVIRONMENTAL SERVICES  
DIVISION OF PLANNING  
AND DEVELOPMENT  
2115 S.E. MORRISON STREET  
PORTLAND, OREGON 97214  
(503) 248-3043

BOARD OF COUNTY COMMISSIONERS  
GLADYS McCOY • CHAIR OF THE BOARD  
PAULINE ANDERSON • DISTRICT 1 COMMISSIONER  
GRETCHEN KAFOURY • DISTRICT 2 COMMISSIONER  
RICK BAUMAN • DISTRICT 3 COMMISSIONER  
SHARRON KELLEY • DISTRICT 4 COMMISSIONER

## LOT LINE ADJUSTMENT

### Statement of Property Owner Consent

We the undersigned property owners, consent to the adjustment of the boundaries of our properties as shown on the attached map.

*(Please print in black ink or type)*

Address \_\_\_\_\_ 250 066C 6/15/91 75.00 71

Legal

Description TOWNSHIP 2 NORTH, RANGE 2 WEST, SECTION 14, TAX LOT 1

Owner's Name LARRY OLSON

Owner's Signature \_\_\_\_\_

Date AUGUST 15, 1991

Address 19100 N.W. SKYLINE BOULEVARD PORTLAND, OREGON 97231

Legal

Description TOWNSHIP 2 NORTH, RANGE 2 WEST, SECTION 14, TAX LOT 16

Owner's Name SHAWN AND LORNA MURRAY

Owner's Signature \_\_\_\_\_

Date AUGUST 15, 1991

Complete and return this form prior to final Planning Division approval of the lot line adjustment.



for

in

AUGUST 29, 1991

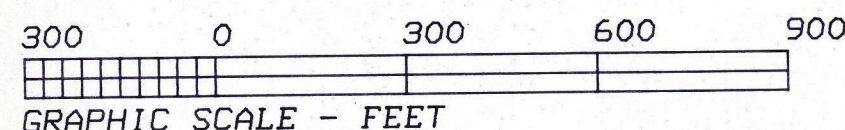

①.....Found monument: 3/4" (I.D.) Pipe unless otherwise noted.  
 ②.....Found monument: 5/8" Iron Rod.  
 O.....Set monument: 5/8" x 30" rebar with red plastic cap stamped  
           "NORTHSTAR PLS 1823".  
 ( ).....Record data from CS 11869.  
 [ ]....." " " CS 38871.  
 { }....." " " Bk 2387, Pg 1307, Multnomah County Deed Records (MCDR).  
 (R).....Radial bearing.  
 R.M.....Reference Monument.  
 P.T.....Point of Tangency.  
 P.C.....Point of Curvature.

CURVE	RADIUS	DELTA	ARC	CHORD BRG & DIST.
1-2	447.50 (447.50)	0°51'21"	6.68	S 5°35'49"E 6.68
2-3	447.50 (447.50)	34°25'15"	268.84	S 63°46'57"E 264.81
4-5	507.50 (507.50)	33°23'16"	295.73 (296.73)	S 23°48'40"E 291.57 (S 23°42'E) (292.52)
6-7	686.30 (686.30)	50°35'13"	605.94 (606.30)	S 32°14'56"E 586.45 (S 32°15'30"E) (586.77)

The purpose of this survey was to transfer 10 acres from TL 1 to TL 16, Map 11-2N-2W, and to monument the land transferred. TL 1 is defined in Bk 1991, Page 860, MCDR, as the south half of the northeast quarter of Section 14. This parcel was monumented per CS 11869, in 1957. I held the pipes from that survey to define the north line of the 10 acres as shown. The south line of the 10 acres was computed as a projection of the north line of the parcel described in Bk 1680, Pg 515, MCDR, which I also monumented as part of this survey. That parcel is described with cardinal bearings. I interpreted that as placing the south line on the E-W centerline of the Section and the east line on the N-S centerline. CS 38871 apparently made the same interpretation.

Skyline Road was monumented per County Road Survey C5/4D. Centerline monuments from that survey were recovered and used for CS 38871. Monuments on the westerly R/W were recovered for CS 39017. I found additional monuments on the easterly R/W and used them, with some of those on the westerly R/W as shown, to recreate the easterly R/W along my client's property.

402 N.W. 5th Street  
Corvallis, Oregon 97330  
Phone: 503-757-9050

REGISTERED  
PROFESSIONAL  
LAND SURVEYOR

*Theodore J. Langton*  
OREGON  
JULY 13, 1979  
THEODORE JAMES LANGTON  
1823

In Accordance With MCC 11. 15.2178(A)  
Case #            Date 30 JUN 1991

Division of Planning &amp; Development

*Gary Clifford*

13