

**BEFORE THE BOARD OF COUNTY COMMISSIONERS  
FOR MULTNOMAH COUNTY, OREGON**

**RESOLUTION NO. 2010-134**

Declaring A Portion Of Multnomah County's Information Technology (IT) Conduit Located At 501 SE Hawthorne Blvd., Portland, Oregon, As Surplus And Requesting Approval Of A Lease Amendment Allowing Tenant, New Cingular Wireless, To Install Fiber Optic Cable Equipment In Surplus IT Conduit.

**The Multnomah County Board of Commissioners Finds:**

- a. When Multnomah County purchased the Multnomah Building it took the position of landlord by assumption of lease with AT&T whose successor is now New Cingular Wireless PCS, LLC (the "Tenant"). This lease provides approximately 333 square feet of space situated in the chiller room of the building penthouse for Tenant's use for communication equipment.
- b. Tenant has requested approval for the installation of fiber optic cable to its equipment. This requires a route through the building. County IT Department has determined that approximately twenty-five percent (25%) of an existing conduit to the chiller room is adequate for tenant's need and does not anticipate County needing this portion of the existing conduit. Approximately fifty percent (50%) of this conduit will remain unused and available for County use.
- c. Tenant has paid a one-time charge of \$6,910.00 for the use of the landlord controlled conduit space.
- d. The County's Facilities and Property Management Program supports this proposed first amendment to the existing lease to allow for Tenant's installation of fiber optic cable to existing equipment on the terms and conditions set forth in the attached lease amendment.

**The Multnomah County Board of Commissioners Resolves:**

1. A portion of Multnomah County's IT conduit in the Multnomah Building is declared surplus to County use and is appropriate for use by the building's existing tenant New Cingular Wireless PCS, LLC.
2. The Board approves the attached lease amendment. The County Chair is authorized to execute the lease amendment attached to this Resolution.

3. The County Chair is further authorized to execute renewals of the above referenced lease and execute amendments to the lease without further Board action.

ADOPTED this 16<sup>th</sup> day of September 2010.



BOARD OF COUNTY COMMISSIONERS  
FOR MULTNOMAH COUNTY, OREGON

  
\_\_\_\_\_  
Jeff Cogen, Chair

REVIEWED:  
AGNES SOWLE, COUNTY ATTORNEY  
FOR MULTNOMAH COUNTY, OREGON

By

  
\_\_\_\_\_  
Matthew O. Ryan, Assistant County Attorney

SUBMITTED BY:  
Mindy Harris, Director, Dept. of County Management

**FIRST AMENDMENT TO STORAGE SPACE RENTAL AGREEMENT #R05  
INSTALLATION OF FIBER OPTIC CABLE**

**BETWEEN: MULTNOMAH COUNTY, OREGON**  
**Facilities and Property Management**  
**401 N. Dixon Street**  
**Portland, OR 97227**

**LANDLORD**

**AND: NEW CINGULAR WIRELESS PCS, LLC**  
**as successor in interest to AT&T WIRELESS**  
**as successor in interest to INTERSTATE MOBILEPHONE CO.**  
**dba CELLULAR ONE**  
**5405 Windward Parkway**  
**PO Box 1630**  
**Alpharetta, GA 30009**

**TENANT**

The parties agree to amend the Rental Agreement as follows:

**A. Installation of Fiber Optic Cable:**

1. Tenant to install fiber optic cable through existing building conduit to Tenant's rooftop receiving antenna per the attached Exhibits C-1, C-2, C-3 and C-4.
2. Payment in the amount of \$6,910.00 for Tenant's use of the additional Landlord controlled conduit space as provided herein shall be due and made upon return of this signed Amendment to Landlord.

**B. Remainder of Agreement**

Except as expressly provided herein, all other terms and conditions of the Rental Agreement shall remain in full force and effect.

IN WITNESS WHEREOF, the parties hereto have executed this Amendment on the respective dates set with their signature below.

**NEW CINGULAR WIRELESS PCS, LLC**  
**as successor in interest to AT&T WIRELESS**  
**as successor in interest to INTERSTATE**  
**MOBILEPHONE CO., dba CELLULAR ONE**

By   
Name \_\_\_\_\_  
Title \_\_\_\_\_

Date 8/24/2010  
Daniel Mikulak III  
Director, Real Estate & Const

**MULTNOMAH COUNTY, OREGON**

By   
Jeff Cogger, Chair

Date \_\_\_\_\_

Reviewed:

By   
Matthew O. Ryan, Asst County Attorney

Date 9/16/2010

AT&T WIRELESS - PTLDORPR98  
501 SE HAWTHORNE BLVD

PORTLAND, OREGON  
MARCH 2010

THIS PROJECT WILL PROVIDE A NEW CONNECTION TO THE ALTA1 WIRELESS TELECOM/FIBER FACILITY LOCATED AT 301 SE HAMMORNE BLVD FROM THE EXISTING TV TELECOM FIBER OPTIC NETWORK BACKLOG LOCATED ON SE 9TH AVE NORTH OF SE CLAY ST. PORTLAND, OREGON

BEGINNING ALONG THE EXISTING ABOVE BACKLOG CABLE ROUTE ON SE 9TH AVE, AN EXISTING SPACE WILL BE UTILIZED A NEW 24" ABSHROUD CABLE WILL OVERLAP THE EXISTING 14" TO SE CLAY AND CONTINUE WEST ON SE CLAY ST. TO THE 6TH FLOOR WHERE A NEW 6" AIR SHAND AND 2" AIR ABSHROUD WILL BE PLACED RUNNING NORTH ALONG AN EXISTING POLE RUN ON SE 6TH AVE. THE NEW 6" AIR SHAND AND 2" AIR ABSHROUD WILL BE ABOVEGROUND AND BE ABOVEGROUND ON THE EAST SIDE OF SE 6TH AVE. IN THE SPAN PRIOR TO THE NEW ROSE A TELEP STRUTTER WILL BE PLACED AND 24" OVER THE STRUTTER WILL CONTINUE INTO THE BUILDING

A NEW 2" RISES A CONDUIT PATH WILL BE PLACED TO THE BUILDING CORE LOCATION A NEW NEMA JUNCTION BOX WILL BE PLACED ON THE INTERIOR OF THE BUILDING AT THE CORE LOCATION AND A 1 1/4" NEMAUL REX CONDUIT WILL BE ROUTED TO THE EXISTING TELECOM JUNCTION BOX ON THE 7TH FLOOR. 24" DWIP CABLE WILL CONTINUE TO THE TELECOM JUNCTION BOX THROUGH THE NEW 2" UNDERGROUND CONDUIT AND 1 1/4" NEMAUL REX CONDUIT PATHWAY.

THE NEW 24" OPTIC FIBER WILL BE PLACED THROUGH THE NEW AND EXISTING CONDUITS TO THE EXISTING 2" CONDUIT THAT ROUTES FROM THE TELECOM JUNCTION BOX TO THE ALTA1 SITE ON THE 7TH FLOOR OF THE BUILDING WHERE THE FIBER WILL ROUTE TO EXISTING CABLE TRAYS TO THE PROPOSED 2" TELECOM RACK LOCATION FOR TERMINATION.

ESTIMATED OPEN CUT (DOR):	—
EXISTING BUILDING ENTRY CONDUIT:	—
ESTIMATED OPEN CUT (A/C):	115'
BACKBONE VAULT:	—
ESTIMATED BONE FTG:	—
BUILDING ENTRY VAULT:	—
ESTIMATED AERIAL FTG. (OVER-LASH):	1000'
OVER-LASH POLE ATTACHMENTS:	7
ESTIMATED AERIAL FTG. (NEW):	400'
NEW POLE ATTACHMENTS:	4

NEW INTERIOR RACEWAY:	~250'
EXISTING INTERIOR RACEWAY:	TBD & CABLE TRAYS IN AT&T ROOM.
EXISTING ENTRY / POI VAULT:	TBD
DAMAGE LOCATION:	PROPOSED TV TELECOM RACK LOCATION
PROPOSED EQUIPMENT LOCATION:	TBD - PRELIMINARY LOCATION SHOWN

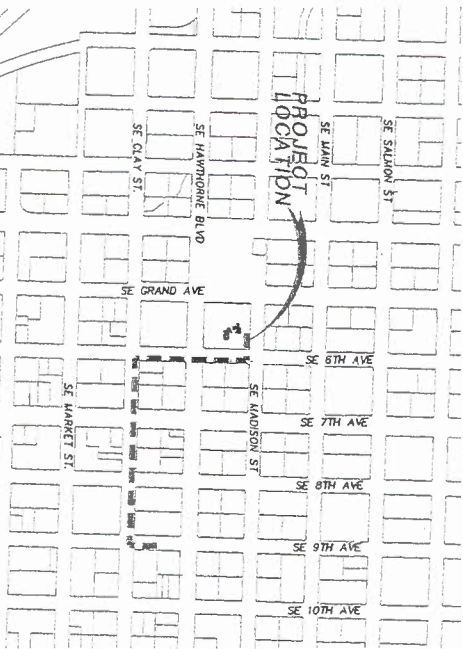
VICINITY MAP  
1" = 500'

**COMMS RPTC**  
  
 1848 W. 4th Ave.  
 Oregon City, Oregon 97045  
 www.commsrptc.com  
 Office: 503.313.4124  
 Mobile: 503.310.8740

DESIGNED BY: R. RAPPE APPROVED BY: E. ORTON  
CHECKED BY: E. ORTON DRAWN BY: R. RAPPE

REVISIONS				
NO.	DESCRIPTION	DATE	BY	APP
	INTERIOR ROUTE CHANGES	3/29/10	NR	-



SHEET NAME	DESCRIPTION
1.0 OF 4	--CONSTRUCTION SET--
2.0 OF 4	COVER SHEET
3.0 OF 4	ARCHIT. PLAN
4.0 OF 4	CIVIL/MECHANICAL PLAN
4.0 OF 4	CABLE MASTER PLAN
1.0	--SPECIFICATIONS SET--
1.1	LEGEND
1.2	GENERAL NOTES
1.3	GENERAL NOTES
1.4	GENERAL NOTES
1.5	OSP DETAILS & SPECIFICATIONS
1.6	TELEPHONE SECTIONS
1.7	TELEPHONE SECTIONS
1.8	MANHOLE DETAILS & SPECIFICATIONS

A1&T WIRELESS  
 19801 SW 72ND AVE, STE 200  
 TUALATIN, OREGON 97062  
 PH. 503.869.1073  
 CONTACT: BRENDA LEFEVRE  
 E-MAIL: BL9589@A1T.COM

TV TELECOM  
 520 SW 6TH AVE, SUITE 300  
 PORTLAND, OREGON 97204  
 DIRECT: 503.416.1522  
 OFFICE: 503.416.1500  
 FAX: 503.416.1555  
 CONTACT: DAVID MINER,  
 PSE ENGINEER (PRINT AND REPEAT)

COMSTRUCTURE CONSULTING  
1634B WATKINS COURT  
OREGON CITY, OR 97045  
OFFICE: 503.343.4134  
MOBILE: 503.310.8340  
CONTACT: ERIK ORTON, OWNER

ATTENTION:  
OREGON LAW REQUIRES YOU TO FOLLOW RULES ADOPTED  
BY THE OREGON UTILITY NOTIFICATION CENTER. THOSE  
RULES ARE SET FORTH IN OAR 932-001-0010 THROUGH  
OAR 932-001-0090. YOU MAY OBTAIN COPIES OF THE  
RULES BY CALLING THE CENTER. (NOTE: THE TELEPHONE  
NUMBER FOR THE OREGON UTILITY NOTIFICATION CENTER IS  
503.246.6699.

MULTNOMAH COUNTY  
501 SE HAWTHORNE  
PORTLAND, OR 97214  
CONTACT: CRAIG FLOWER - PROPERTY MANAGER  
PH: 503.969.1462  
EMAIL: CRAIG.M.FLOWER@CO.MULTNOMAH.OR.US

**ADVANCE TECHNICAL SYSTEMS**  
CONTACT: BRIAN FLEMING  
PH: 503.849.5780

---

**OUTSIDE PLANT**

---

**UTILITY TECHNOLOGIES, INC.**  
CONTACT: JOE CRISWELL  
PH: 503.764.6962

UTILITY TECHNOLOGIES, INC.  
CONTACT: JOE CRISWELL  
PH: 503.764.6962



POTENTIAL UNDERGROUND  
FACILITY OWNERS  
"ONE CALL"  
UTILITY NOTIFICATION CENTER  
246-6699

AT&T WIRELESS - PTLDORP08  
601 SE HAWTHORNE BLVD - PORTLAND  
COVER SHEET

CITY: PORTLAND	COUNTY: MULTNOMAH
DATE: 1/29/10	
SCALE: AS SHOWN	
PROJECT #: TV-DB08	
FILENAME: TV-DB08-BE03.DWG	
	SHEET 10 OF 4



# CONSTRUCTION SET

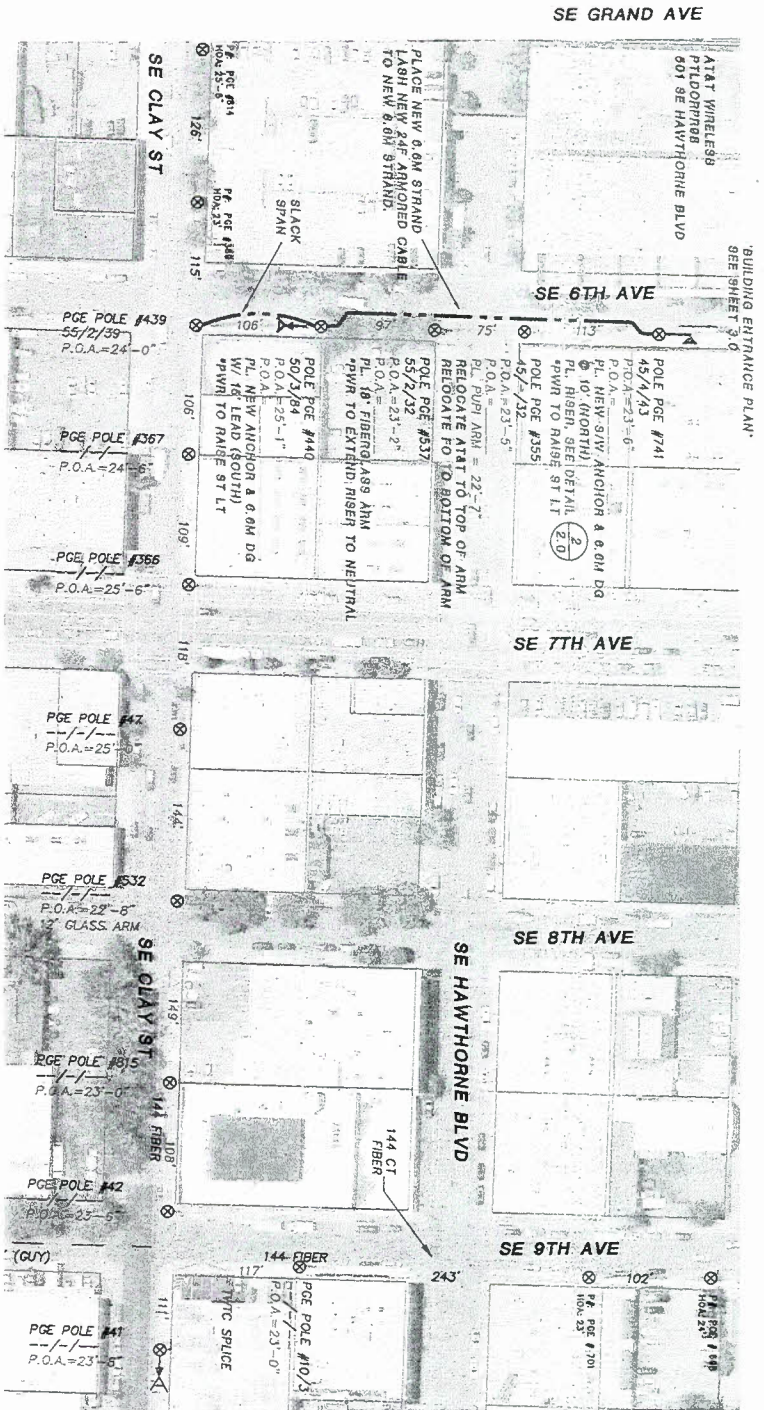

AERIAL PLAN  
601 SE HAWTHORNE BLVD  
SCALE: 1"=100'

RISER DETAIL  
SE 6TH AVE  
SCALE: 1"=10'

\*POWER MAKE READY NOTE.  
SOME POWER MAKE READY LISTED MAY CHANGE PRIOR TO CONSTRUCTION.  
POLE #741, 637 & 438 ARE SCHEDULED TO BE REPLACED.



DESIGNED BY: R. RAPPE	APPROVED BY: E. ORTON
CHECKED BY: E. ORTON	DRAWN BY: R. RAPPE
REVISIONS	DATE BY APP
1 INTERIOR ROUTE CHANGES	3/29/10 ROR

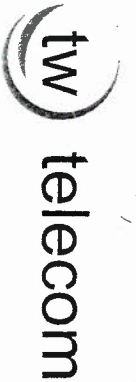

CITY: PORTLAND	SCALE: AS SHOWN	PROJECT #: TW-PR98	FILENAME: TW-PR98-BED3.DWG	COUNTY: MULTNOMAH
DATE: 3/29/10				SHEET: 2.0 OF 4

AT&T WIRELESS - PTDORP88  
601 SE HAWTHORNE BLVD - PORTLAND  
AERIAL PLAN

OUTSIDE PLANT (OSP) PERFORMED BY INSIDE PLANT (ISP) PERFORMED BY

1. The first group of authors (e.g., [1, 2]) considers the problem of the stability of the motion of a system of particles in the field of a central body. The results of these studies are used in the theory of the motion of celestial bodies.

SIDEWALK TYPICAL.  
ACTUAL POSITION WILL VARY.

ADDITIONAL COMMENTS

# AND COLLISION STATE

SCALE: 1"=MIS

10



81E

SEE SHEET 2.0

 $\frac{2}{2.0}$ 

## IS<sup>2</sup> CONSTRUCTION NOTES

1. SEE DETAIL 2.0
2. PL. 2" SCH 40 PVC CONDUIT @ 36" DEPTH FROM MISER TO BUILDING. REPLACE A/C'S AS REQUIRED. PL. 24F OF-TRP CABLE & LOCATE WIRE IN NEW 2" CONDUIT.
3. CORE LOCATION (VERIFY Y LOCATION PRIOR TO PLACEMENT OF NEW BUILDING ENTRY CONDUIT). PL. 6"x12"x12" NEUTRA BOX ON INTERIOR BUILDING WALL ABOVE CRUIERS MTS. SEAL CORE AND CONDUIT AS REQUIRED. UNLIVE CORE SLEEVE & LINK SEAL OR SULLER GASTRESSION SEAL. SEE DETAIL TYP. OSP CONSTRUCTION TRENDS HERE. HAND OFF POINT TO ISP.

[illegible]

ATAT WINELE99

601 SE HAWTHORNE BLVD  
—EXISTING AIRT ROOM ON 7TH FLOOR

EXISTING JUNCTION BOX AND 2" TELCO CONDUIT PATHWAY

RECEIVED  
PROPOSED  
DEMARC  
FBI  
BEGINS IN 6TH FLOOR RISER CLOST.

10

PL. 1-1 1/4 PLENUM FLEX DUCT IN APPROVED  
EXISTING 4" RISER SLEEVES TO EXISTING DEDICATED  
AIR/PATHWAY JUNCTION BOX ON 7TH FLOOR.

[illegible]

1ST FLOOR 4 ENT TRANSITION  
TO 2ND FLOOR RISER ROOM.

**BASEMENT**

3	4				PHONE ROOM
---	---	--	--	--	------------

**BUILDING ENTRY PLAN  
BUILDING PROFILE**

SCALE: 1"=100'-0"

AT&T WIRELESS - PTLDRP08  
604 SE HAWTHORNE BLVD PORTLAND

**BUILDING ENTRANCE PLAN**  
801 SE HAWTHORNE BLVD - FORTLAND

PORTLAND	SCALE:	PROJECT #	DESIGNER:	COUNTY: MULTNOMAH
				SHEET

3/29/10	AS SHOWN	TM-PR98	TM-PR98-BEQ3.DWG	3.0 OF 4
---------	----------	---------	------------------	----------

EXHIBIT C

DESIGNED BY: <u>R. RAFFE</u>	APPROVED BY: <u>E. ORTON</u>			
CHECKED BY: <u>E. ORTON</u>	DRAWN BY: <u>R. RAFFE</u>			
REVISIONS				
REV	DESCRIPTION	DATE	BY	APP
1	INTERIOR MOULD CHANGES	3/29/10	RON	-

<b>AT&amp;T WIRELESS - PLTDOORP88</b> <b>601 SE HAWTHORNE BLVD - PORTLAND</b> <b>BUILDING ENTRANCE PLAN</b>		COUNTY: MULTNOM
DATE: 3/29/10	SCALE: AS SHOWN	SHEET 3.0 of 4
PROJECT # 111-PR98		TITLEPAGE: 111-PR98-BE03.DWG
TX: PORTLAND		

# CONSTRUCTION SET

## OSP CONSTRUCTION NOTES

- (1) PL. 24F ARMORED FIBER OPTIC CABLE.
  - (2) PL. 24F ONP CABLE & LOCATE WIRE TO BUILDING ENTRY LOCATION WITHIN NEW 2" CONDUIT.
  - (3) OSP CONSTRUCTION EMBOS HERE; HAND OFF POINT TO ISP.
- ### ISP CONSTRUCTION NOTES
- (4) PL. 24F ONP CABLE TO NEW 1 1/4" PLUMB LINE ROOM, ROUTE TO BUILDING TO 7TH FLOOR FIBER RACKING ROOM. ESTABLISH RACK ROOM, WITH 1" CONDUIT CABLE AND CABLES & CABLES ACCORDING TO FLOOR PLAN. CABLE PLACEMENT.
  - (5) PL. 24F ONP CABLE TO 1" CONDUIT FIBER RACK ROOM, 2" CONDUIT TO 7TH FLOOR TO 4241 VIL.
  - (6) POWER TO EXISTING CASE, WITH NEW TO PROPOSED TO BUILDING TO 7TH FLOOR TO 4241 VIL.



SE HAWTHORNE BLVD

SE 6TH AVE

SE CLAY ST

PL. 100' SLACK LOOP 24F ARMORED CABLE.  
PL. 100' SLACK LOOP 24F ONP CABLE.  
PREP FOR SPLICE.

NEW TW TELECOM 6.0M STRAND.  
PL. 24F ARMORED CABLE.

NEW TW TELECOM 6.0M STRAND.  
PL. 24F ONP CABLE.

PROPOSED TW TELECOM OFFERING LOCATION.  
LEAVE TO SLACK ROOM OF NEW 24F OPTIC CABLE.

EXISTING  
TELCO  
BOARD

EXISTING  
TELCO  
CONDUIT

CABLE PLAN  
AT&T EQUIPMENT ROOM  
SCALE: 1"=1'-0"

4.0

BUILDING ENTRY CABLE PLAN  
BUILDING PROFILE  
SCALE: 1"=1'-0"

3.0

SE MADISON ST.

SE 9TH AVE

144 FIBER

117' TWIC SPLICE

111'

100'

108'

144 FIBER

149'

108'

117'

100'

108'

144 FIBER

149'

108'

117'

100'

108'

144 FIBER

149'

108'

117'

100'

108'

144 FIBER

149'

108'

CABLE MASTER PLAN - AERIAL  
601 SE HAWTHORNE BLVD  
SCALE: 1"=1'-0"

1.0

24CT ARMORED FIBER CABLE  
REEL #  
SEQUENTIAL BEGIN END

2.0

24CT ONP FIBER CABLE  
REEL #  
SEQUENTIAL BEGIN END

3.0

24CT ONP FIBER CABLE  
REEL #  
SEQUENTIAL BEGIN END

4.0

CABLE MASTER PLAN - UG/ISP  
601 SE HAWTHORNE BLVD  
SCALE: 1"=1'-0"

4.0

2.0



DESIGNED BY: R. RAPE	APPROVED BY: E. ORTON
CHECKED BY: E. ORTON	DRAWN BY: R. RAPE
REVISIONS	DATE BY APP
1. INTERIOR ROUTE CHANGES	3/29/10 ROK -

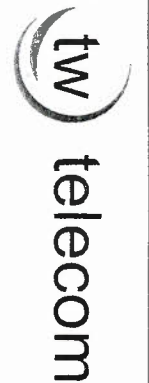

CITY: PORTLAND	SCALE: AS SHOWN	PROJECT #	FILENAME:	COUNTY: MULTNOMAH
DATE: 3/29/10		TW-PR98	TW-PR98-BE03.DWG	SHEET 4.0 OF 4

AT&T WIRELESS - PILDORPH08  
601 SE HAWTHORNE BLVD - PORTLAND  
CABLE MASTER PLAN